

Digital Piano

USER MANUAL

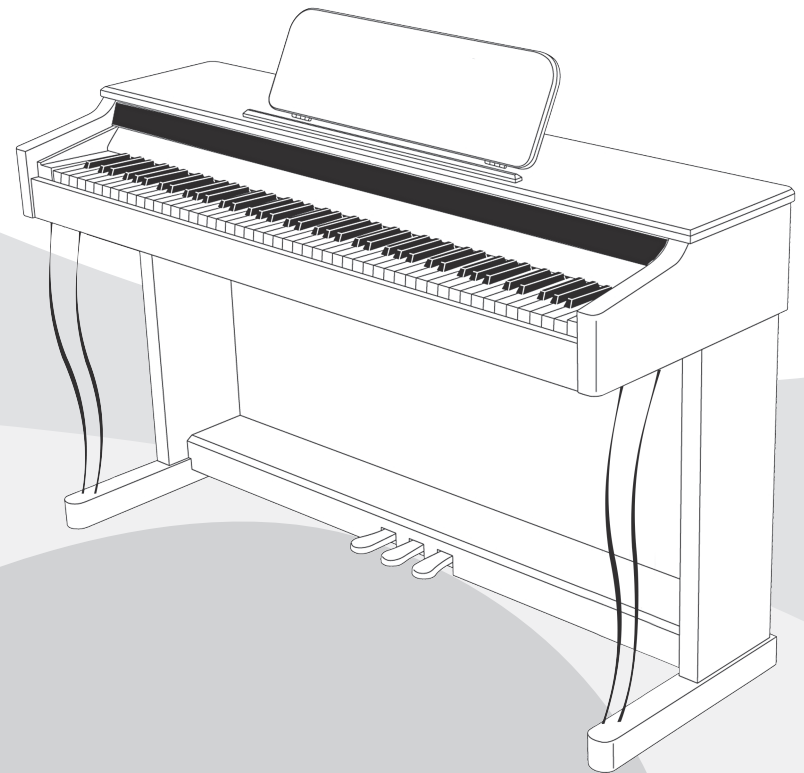

THE CAGE IS NOT INCLUDED FOR INFORMATIONAL PURPOSES ONLY

Welcome To Use Digital Piano

Thank you for your purchase of this digital keyboard. This digital keyboard is elegant and refined, combined perfectly with handle and timbre of traditional keyboard and latest electronic technology of the present age.

- ◆ Before using this musical instrument, you should read this manual book in detail.
- ◆ please keep all user files properly as to look up when needed in days to come

CONTTENT

1.Function Introduction	2-3
2.Safety Caution	4-5
3. Installation Graphic Representation	5
4.FUNCTIONAL INDICATOR	6
5.Connection	7
6.JACK SOCKET	8
7.BASIC OPERATION	9-12
8.Tone List	13-14
9.Rhythm List	15-17
10.Demo List	18
11.Single Finger Chord List	19
12.Multi-Finger Chord List	20-21
13.Product Maintenance	22

Function Introduction

Appealing tone

It adopts Dream source , with digitization sampling, which provide vivid as acoustical experience for your performance

128 tones that are plentiful and top grade

which include 128 standard GM tones,

100 preset rhythms

There are 100 rhythms, including all sorts of accompaniments, ranging from rock-and-roll to pop music and jazz, which enable you to experience various feelings.

88 Demo songs

88 demos of various styles are selected with great care to be played.

USB / MIDI terminal

Use USB or MIDI terminal. and you can connect it to the computer or other MIDI devices for interaction and creation quickly and conveniently .

function list

- 88 Keys Keyboard
- 128 Tones
- 100 Rhythms
- 88 Demos in the library
- LCD display
- Master volume / ACC volume control
- Tempo control / Transpose control
- chord function
- Accompaniment synchronization
- Keyboard split function
- Touch control / Transfer metronome
- USB/MIDI capability
- Headphone jack / Stereo audio input

Safety Caution

Warning

Smoke , peculiar smell, overheat

When this musical instrument smokes, gives off peculiar smell or is overheat, continuing in service may result in fire and electric shock. When the above cases occur, you shall carry out the following operations immediately.

- 1.turn power off .
- 2.please unplug plug of AC transformer from the outlet.
- 3.contact your dealer.

AC transformer

- The misapplication of AC transformer may result in fire and electric shock. You shall abide by the following caution notes.

1. You shall use special AC transformer appointed for this product.
2. You shall use AC power supply whose output voltage is within the range of voltage rating marked on the AC transformer.
3. You shall not make the outlet and power extension line overload

You shall never touch AC transformer with wet hand, otherwise it may result in electric shock.

- please use AC transformer where may not touch water. Water may result in fire and electric shock.
- You shall never place vase or any other containers with water on AC transformer .Water may result in fire and electric shock

Notice

AC transformer

• The misapplication of AC transformer may result in fire and electric shock. You shall abide by the following caution notes.

1. You shall never place power line near kiln or other heaters.
2. When unplugged from the outlet, the power line shall never be pulled and dragged.

You shall grasp the body of AC transformer plug.

3. You shall insert the AC transformer into the outlet to the end.

Volume

You shall never play music with high volume for a long time. When using earphone, you shall take particular care. Too high volume may do harm to your hearing.

Installation Graphic Representation

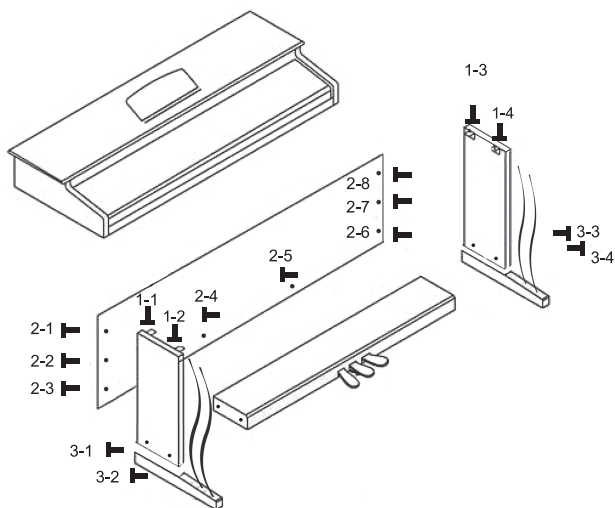

1. 1-1 to 1-4 plastic fix part screw M6X25 (4PCS)
2. 2-1 to 2-8 screws M6X20 (8 PCS)
3. 3-1 to 3-4 screws M6X60 (4 PCS)

FUNCTLANAL INDICATOR



Connection

Audio Input Interface

Before external audio signal is connected to this product, please turn down the volume of tone source at first. Adjust the volume to the satisfactory level after connection.

Connecting wire, which is sold into the open where both ends are standard plugs (for instance : for MP3)

or one end is standard plug while the other end is two needle shaped plug (for instance : for DCD) , is used to connect tone source output unit and digital keyboard , and when you switch on power switches of tone source instrument and digital keyboard, you can play music on the tone source instrument of the digital keyboard, or you can also play music while play the musical instrument

USB / MIDI Interfaces

MIDI is initial letters of Musical Instrument Digital Interface in English. MIDI is the standard connecting system of communication between digital keyboard and music instrument with MIDI USB or MIDI interfaces of this digital keyboard can be used to connected with music instrument accompanied with MIDI and computer.

Earphone Output Terminal

This product has one earphone output faucets, and turn down volume of the digital keyboard at first before connecting earphone. Adjust the volume to the satisfactory level after connection

JACK SOCKET

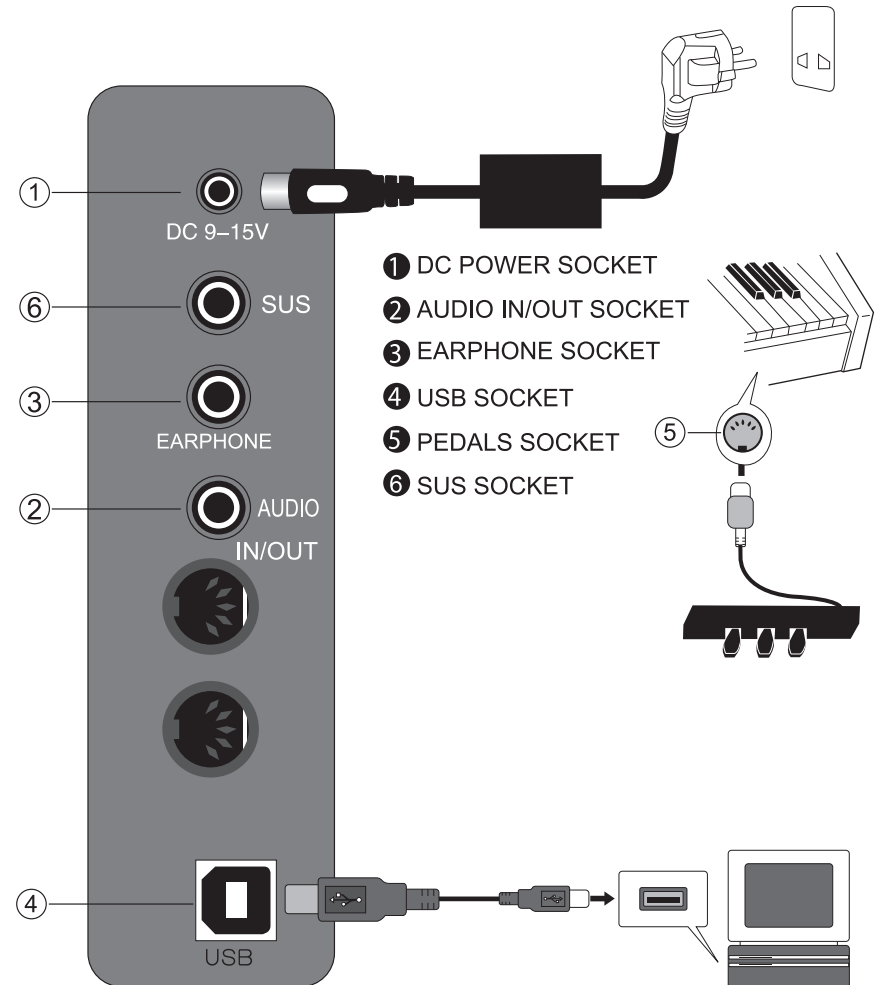

Basic Operation

Piano performance

1. Press the power switch, and the power indicator and digital tube will light up, and then you can enter the playing state.
2. Play music on the piano keys.

Volume adjustment

Press the "volume +" or "volume -" button to increase or decrease the volume until it is satisfactory.

Timbre selection

1. Press "timbre/rhythm" button, and the indicator light will be on to enter timbre mode.
2. Press "select +" or "select -" to select any timbre, and the corresponding timbre number will be displayed digitally.
3. When the power switch is turned on, it is preset to the piano tone, with a total of 128 tones.

Rhythm selection

1. Press the "Tone/Rhythm" button, the key light goes out and enters the rhythm mode.
2. Press "Select+" or "Select-" to select any rhythm, digital display of the corresponding rhythm number.
3. Press the "Start/Stop" key to start playing the selected rhythm. Pressing "Insert 1" or "Insert 2" inserts a piece of cross-door music to stop the rhythm play press "Start/Stop".

Speed adjustment

1. Press the "Speed" button and press "Select+" or "Select-" to adjust the speed and speed.
2. Speed control range (20-280), power-up preset in paragraph 120.

Chord accompaniment

1. Select the desired rhythm to play.
2. Press and hold the "Tone/Rhythm" and "Function" buttons at the same time to enter the chord state.
3. Playing chords can be played differently on the accompaniment keyboard (1-34 keys from left) according to different fingering.
4. Press and hold the "Tone/Rhythm" and "Function" buttons again to turn off the chord function.

Shift ingdulation

1. Press the "Function" button, digital display "0" into the transfer selection function.
- 2.2. Press "Select +" or "Select-" to select different shift values (-12-12).

Force function

1. Press the "function" button, the function light lights up, digital display inverted "F" when entering the force adjustment function.
2. Use "Select+" or "Select-" to select force on or force off.

Metronome features

Press the metronome button, the light lights up, the metronome function starts, and then press the key metronome function off.

Built-in Demo Song

1. At the same time, press and hold the "Select +" "Select -" Digital display of the current demonstration song number, start playing the demonstration song continuously.
2. Entering the demonstration mode can also be "select +" or "select-" to select a

different demonstration song.

3. Press "Select+" and "Select-" again to exit the demonstration mode.

Recording

1. Key disc note recording

Press the "Start/Stop" and "INTRO/End" buttons simultaneously to digitally display "REC" into recording mode, recording 5000 notes.

2. Sounding Press "Insert 1" and "Insert 2" digitally display "PLY" to play the recorded notes.

SPLIT

1. Press the "Function" button, the function light goes on, and the digital display of the first letter "S" enters dual keyboard selection mode.

2. Use "Select +" or "Select-" to select both keyboard on or double keyboard off.

3. Play notes on the keyboard, at this time playing the keyboard left and right each issued the corresponding sound of the instrument

DUAL

1. Press the "Function" button, the function light goes on, and the digital display of the first letter "d" enters dual selection mode.

2. Use "Select+" or "Select-" to select a two-tone on or two-tone switch.

3. Play notes on the keyboard, at which point playing the keyboard can emit two corresponding resonance tones at the same time.

Accompaniment volume adjustment

1. Press the "function" button, the function light lights up, digital display "024" into and put accompaniment volume adjustment mode.

2. Use "Select +" or "Select-" to select a different accompaniment volume (0-32).

Storage function

1. After setting the various parameters that need to be remembered at present, you can press and hold the "Storage 1" or "Storage 2" button, the corresponding light flashes to indicate that the current setting has been remembered.

2. When playing, you need to release the corresponding parameters, just press the corresponding button to release quickly.

TONE LIST:

编号 (Number)	Instrument
PIANO(钢琴)	
001	GRAND PIANO 1
002	BRIGHT PIANO 1
003	PIANO ELEC
004	HONKY-TONK
005	E PIANO1
006	E PIANO2
007	GRAND HARPSICHORD
008	CLAVI CHORD 1
GLOCK(钟琴)	
009	CELESTA
010	GLOCKENSPIEL 1
011	MUSIC BOX 1
012	VIBRAPHONE 1
013	MARIMBA 1
014	XYLOPHONE 1
015	TUBULR BELLS 1
016	DULCIMER 1
ORGAN(风琴)	
017	HAND ORGAN 1
018	PERCHY ORGAN 1
019	ROCK ORGAN
020	CHURCH ORGAN 1
021	REED ORGAN 1
022	ACCORDN 1
023	HARMONICA 1
024	TANGO ACCORDN 1
GUITAR(吉它)	
025	GUITAR NYLON 1
026	GUITAR STEEL 1
027	GUITAR JAZZ 1
028	GUITAR CLEAN 1

029	GUITAR MUTED 1
030	GUITAR OVRDRV
031	GUITAR DISTRT 1
032	GUITAR HRMNX
BASS(贝司)	
033	ACOUSTIC BASS 1
034	FINGER BASS 1
035	ELECT BASS 1
036	FRETLS BASS
037	SLAP BASS 1
038	SLAP BASS 2
039	SYN BASS 1
040	SYN BASS 2
STRING(弦乐)	
041	VIOLIN 1
042	VIOLA 1
043	CELLO 1
044	CONTRABASS 1
045	STR TREM 1
046	STR PIZZ
047	HARP 1
048	TIMPANI 1
CONCERT(合奏)	
049	STRINGS 1
050	STRINGS 2
051	STR SYN 1
052	STR SYN 2
053	CHOIR AAHS 1
054	VOICE OOHs 1
055	VOICE SYN
056	ORCH HIT 1
BRASS(铜管乐)	
057	TRUMPT 1
058	TROMBONE 1
059	TUBA 1
060	MUTE TPT 1
061	FR HORN 1
062	BRASS SECT 1
063	BRASS SYN 1
064	BRASS SYN 2
PIPE(管乐器)	

065	SAX SOPRANO
066	SAX ALTO 1
067	SAX TENOR 1
068	SAX BTONE 1
069	OBOE 1
070	ENG HORN 1
071	BASSON 1
072	CLARINET 1
WOODPIPE(木管乐器)	
073	PICCOLO 1
074	FLUTE 1
075	RECORDER 1
076	PAN FLUTE
077	BOTTLE BLOWN
078	SHAKHACHI
079	WHISTLE 1
080	OCARINA
SYNTH PIPE(合成管乐)	
081	SQR WAVE
082	SAW TOOTH
083	CALLIOPE
084	CHIFF
085	CHARANG
086	VOICE
087	FIFTHS
088	BASS LEAD
SYNTH VOICE(合成音色)	
089	NEW AGE
090	WARM PAD
091	POLY SYNTH
092	CHOIR PAD 1
093	BOW GLASS 1
094	METAL PAD 1
095	HALO PAD 1
096	SWEEP
SYNTH EFFECT(合成效果)	
097	RAIN FX
098	SNDTRK FX
099	CRYSTAL FX
100	ATMOSPH FX

101	BRIGHT FX
102	GOBLIN FX
103	ECHO FX
104	SCI-FI FX
FOLK SOUND(民族乐器)	
105	SITAR 1
106	BANJO 1
107	SHAMISEN 1
108	KOTO 1
109	KALIMBA
110	BAGPIPE
111	FIDDLE
112	SHANAI
PERCUSSION(打击乐器)	
113	TINKLE BELL
114	AGOGO
115	STEEL DRM
116	WOODBK
117	TAIKO DRM
118	MLDY TOM
119	SYNTH DRM
120	REVRS CYM
EFFECT(效果音色)	
121	GTR NOISE
122	BREATH 1
123	SEASHORE
124	BIRD TWEET 1
125	TELEPHONE
126	HELICOPTER
127	APPLAUSE
128	GUNSHOT 1

USER MANUAL

RHYTHM LIST:

8 BEAT	001	8 Beat 1A
	002	8 Beat 2A
	003	8 Beat 3A
	004	8 Beat 4A
	005	8 Beat HeatA
	006	8 Beat Pop 1A
	007	8 Beat Pop 2A
BALLAD	008	Ballad 1A
	009	Ballad 2A
	010	Guitar BalladA
	011	Organ BalladA
	012	Bluse BalladA
	013	Epic BalladA
	014	Rock BalladA
	015	Slow BalladA
	016	Pop Ballad
	017	Electro Pop BalladA
	018	Polk BalladA
16 BEAT	019	16 Beat 1A
	020	16 Beat 2A
	021	16 Beat 3A
	022	16 Beat 4A
	023	16 Beat FunkA
	024	16 Beat Pop A
	025	16 Beat BalladA
LATIN	026	Bossa Nova 1A
	027	Guitar BossaA
	028	Pop BossaA
	029	TangoA
	030	Cha ChaA
	031	RhumbaA
	032	TEX TEXA
COUNTRY	033	CountryA
	034	Country RockA
	035	Country ShuffleA
	036	Country SwingA
	037	Country BalladA
	038	Country WaltzA

USER MANUAL

ROCK R&B	039	50's RockA
	040	Heavy MetalA
	041	Rock 1A
	042	Rock 2A
	043	Soft RockA
	044	Slow RockA
	045	Hard RockA
	046	Rock & Roll 1A
	047	Rock & Roll 2A
RHYTHM&BLUES	048	Chicago BluesA
	049	Fast GospelA
	050	Groove Soula
	051	RapA
	052	GospelS1A
	053	BluesA
	054	Slow BluesA
	055	FoxtrotA
Disco	056	Disco TropicA
	057	Disco HandsA
	058	Two StepA
	059	Polk PopA
	060	Waltz 1A
	061	Waltz Pop 1A
	062	Waltz Pop 2A
WORLD MUSIC	063	RaiA
	064	Twist 1A
	065	Twist 2A
	066	Miami PopA
	067	MotownA
	068	ReggaeA
	069	Swing ReggaeA
	070	MamboA
	071	BeguineA
	072	MusetteA

USER MANUAL

DANCE	073	HouseA
	074	Slow FoxA
	075	Vienna WaltzA
	076	SalsaA
	077	DiscoA
	078	Hip Hop PopA
	079	Analog PopA
	080	Club DanceA
JAZZ&SWING	081	BoogieA
	082	Funky PopA
	083	Jazz RockA
	084	Swing 1A
	085	DixielandA
	086	Jazz SambaA
TRADITIONAL	087	MarchA
	088	US. MarchA
	089	Samba A
	090	PolkaA
	091	Polka OberA
	092	TarantellaA
	093	Slow WaltzA
	094	Ober WaltzA
PINIST	095	Piano Ballada
	096	Waltz 2A
	097	Guitar WaltzA
	098	2/4 Piano 1A
	099	3/4 Piano 1A
	100	4/4 Piano 1A

USER MANUAL

DEMO LIST:

NO	SongName	NO	SongName
001	MinutWlz	045	Polka
002	DJ Dance	046	SoilPull
003	Fountian	047	Trout
004	SpanGirl	048	Send-off
005	SonataPn	049	March
006	SuperSng	050	ForElise
007	LittlBee	051	SwaniRiv
008	HorseRac	052	France
009	Nocturne	053	Danube
010	TheSpain	054	Hungary
011	BusyTran	055	Spaceman
012	Mexico	056	Patriot
013	MozartPn	057	Cuckoo
014	Minuet	058	SingKite
015	Nifuma	059	TongChil
016	Disco	060	DoReMi
017	FolkSong	061	We Happy
018	Girl Sea	062	LittlBee
019	LittStar	063	Russia
020	KindeGtn	064	Plaster
021	Wahaha	065	Foison
022	Duck&Cik	066	JingleBe
NO	SongName	NO	SongName
023	Humorous	067	PaperBoy
024	Joy Song	068	Swallow
025	GoingHom	069	New Year
026	Dove	070	Edelweis
027	Auldlang	071	MoonRivr
028	Moonligh	072	Beyer 10
029	HapyBirh	073	Beyer 20
030	PraiseSng	074	Beyer 30
031	Dolly	075	Beyer 40
032	Market	076	Beyer 50
033	Family	077	Beyer 60
034	A cradle	078	Beyer 70
035	At Home	079	Beyer 71
036	Seasons	080	Beyer 72
037	YearsAgo	081	Beyer 75
038	Pigeons	082	Beyer 76
039	InnerVic	083	Beyer 77
040	Violin	084	Beyer 78
041	Swan	085	Beyer 79
042	Musettes	086	Beyer 80
043	GypsyRnd	087	Beyer 90
044	Serenade	088	Beyer 98

Single Finger Chord List

	M	m	7	m7
C				
C#				
D				
D#				
E				
F				
F#				
G				
G#				
A				
A#				
B				

Multi-finger Chord List

C	Cm	C7	Cm7	Cdim7	CM7	Cm7-5	Cdim
C#/(Db)	C#/(Db)m	C#/(Db)7	C#/(Db)m7	C#/(Db)dim7	C#/(Db)M7	C#/(Db)m7-5	C#/(Db)dim
D	Dm	D7	Dm7	Ddim7	DM7	Dm7-5	Ddim
(D#)/Eb	(D#)/Eb m	(D#)/Eb 7	(D#)/Eb m7		(D#)/Eb M7	(D#)/Eb m7-5	(D#)/Eb dim
E	Em	E7	Em7		EM7	Em7-5	Edim
F	Fm	F7	Fm7		FM7	Fm7-5	Fdim
F#/(Gb)	F#/(Gb)m	F#/(Gb)7	F#/(Gb)m7		F#/(Gb)M7	F#/(Gb)m7-5	F#/(Gb)dim
G	Gm	G7	Gm7		GM7	Gm7-5	Gdim
(G#)/Ab	(G#)/Ab m	(G#)/Ab 7	(G#)/Ab m7		(G#)/Ab M7	(G#)/Ab m7-5	(G#)/Ab dim
A	Am	A7	Am7		AM7	Am7-5	Adim
(A#)/Bb	(A#)/Bb m	(A#)/Bb 7	(A#)/Bb m7		(A#)/Bb M7	(A#)/Bb m7-5	(A#)/Bb dim
B	Bm	B7	Bm7		BM7	Bm7-5	Bdim

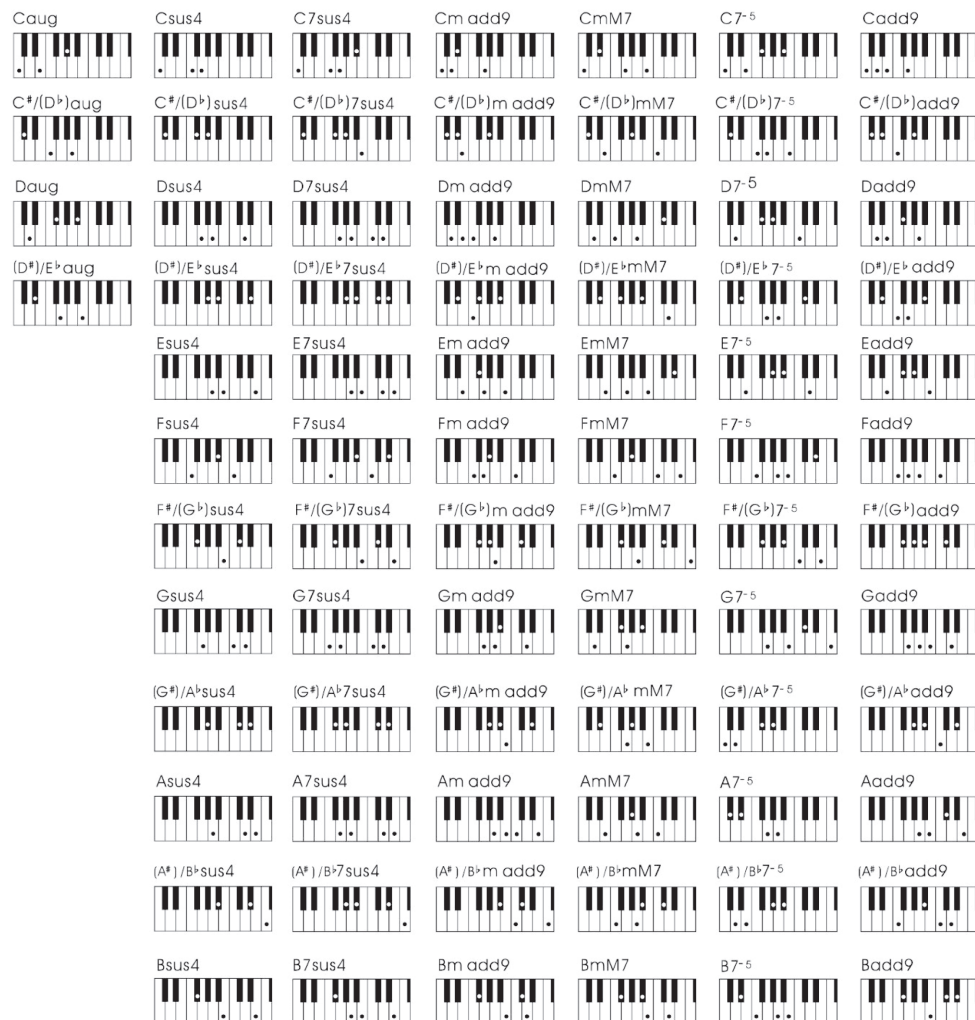

Product Maintenance

Careful and good maintenance and production of this product play a very important role in lengthen service life of the product and decrease fault.

Avoid heating ,Damping or direct Sunlight

You shall not have the musical instrument exposed to sunlight in excess, or placed where is near air conditioner or baking hot

you should not use it near TV set or radios

This musical instrument may lead to video or audio disturbance on TV set and Radio .In that case, you shall move the musical instrument away from TV set or radio

You should not use paint ,thinner or similar chemicals to clean

You can clean this product a piece of soft cloth with weak solution and neutral detergent. The piece of cloth shall be dipped and wrung out in the solution until it is dry approximately.

you should avoid quake and collision

The product shall be handled with care when removing with strict prohibition of strenuous quake and collision in order not to make outer shell or innerelectronic components damaged.

Avoid using where is easy to be affected by abnormal high and low temperatures

Too high or low temperature may make pictures on LCD screen turn to be gray and hard to be identified. When you have the product under normal temperature, the case will be corrected automatically.