

Digital piano

Operating instruction

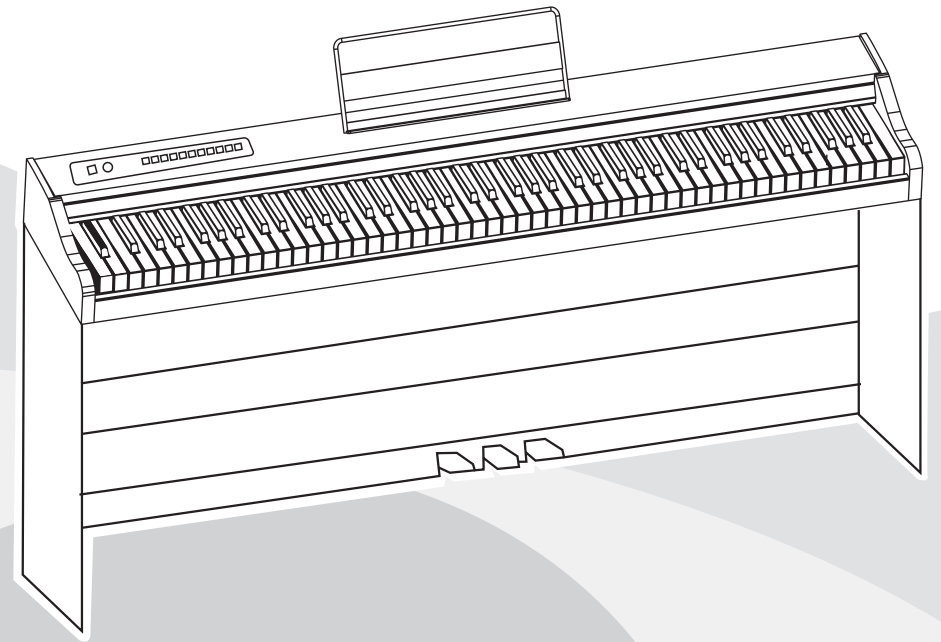

Thank you for choosing this digital piano from our company. This digital piano is elegant and exquisite, a perfect combination of the latest electronic technology. Read this instruction carefully before using the instrument.

 **Use DREAM sound source**

Its core uses French DREAM top sound source, digital sampling, for your performance to bring a realistic auditory experience.

 **88 progressive heavy hammer keys, all with heavy hammer keyboard**

The 88-key progressive lever hammer keyboard gives you the real feel of playing on a grand piano.

 **Headphone jack**

External headphone jack, in the front function box of the digital piano, easy to play without affecting others.

 **Audio jack**

External sound socket, function board at the back of the digital piano, can be convenient for external sound, performance playing.

Special remind:

This product is an electronic acoustic musical instrument. It is normal to have a little current sound in the speaker (two speakers or one speaker or earphone) after power on. Please keep away from radio, TV, antenna receiver, router, refrigerator, electrical appliances with motors and other RADIO frequency electrical interference sources during use.

Installation Graphic Representation

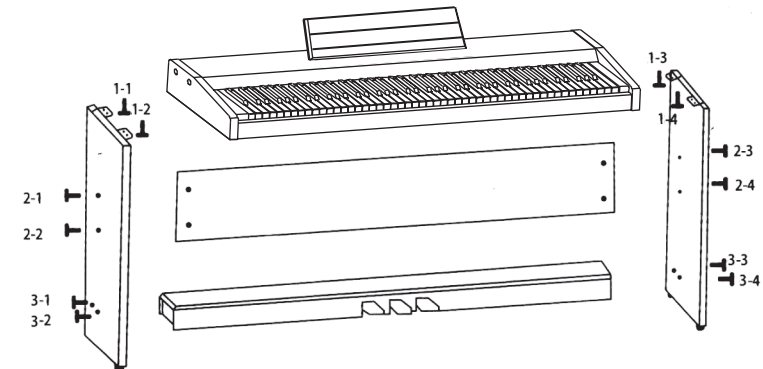

1. 1-1 to 1-4 plastic fix part screw M6X25(4PCS)
2. 2-1 to 2-4 screws M5X50 (4 PCS)
3. 3-1 to 3-4 screws M6X50 (4 PCS)

Notice:

**Portable pianos don't have stands,
The bracket is selected by the customer.**

JACK SOCKET

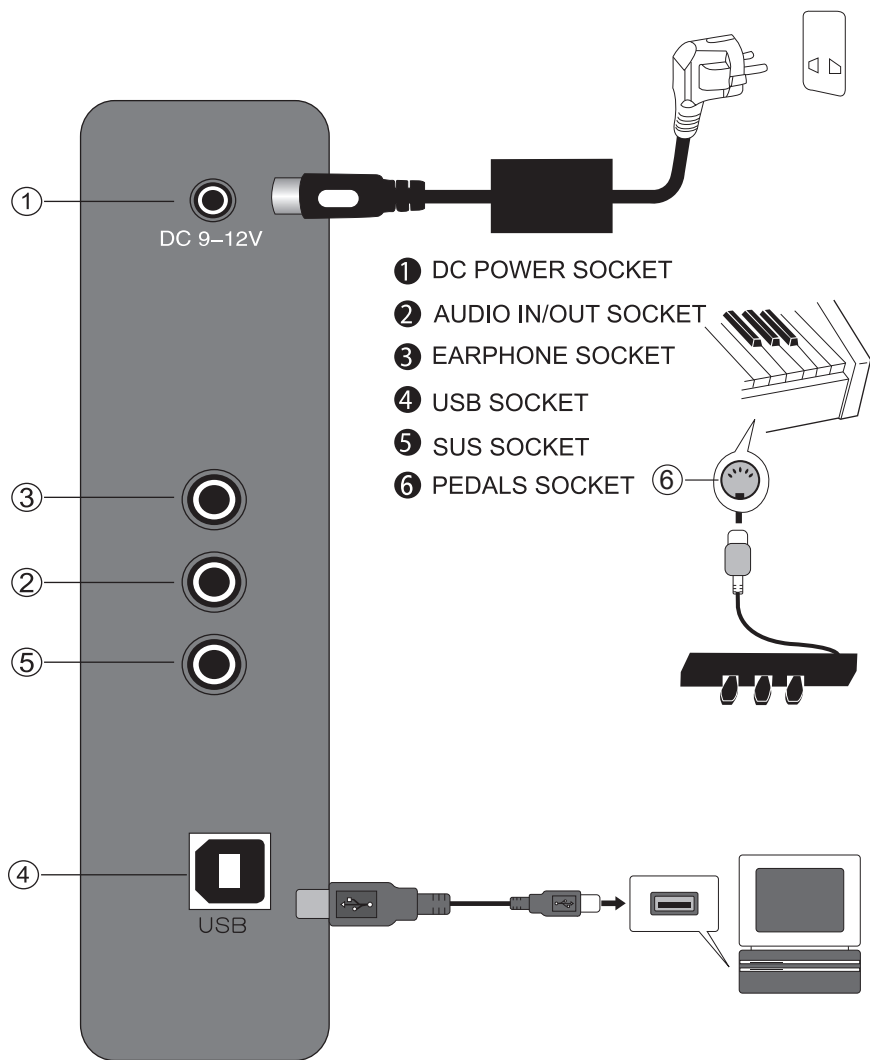

- ① DC POWER SOCKET
- ② AUDIO IN/OUT SOCKET
- ③ EARPHONE SOCKET
- ④ USB SOCKET
- ⑤ SUS SOCKET
- ⑥ PEDALS SOCKET

1 Power Cable Connection

1. When using, connect the power cord according to the diagram, one end is inserted into the power socket in the piano rear operating board, the other end is inserted into the household power socket. (figure 1)
2. When not using the product for a long time, please unplug the power cord and keep it properly.

2 Audio input/output jack

1. Audio output jack can be connected to large speaker equipment externally.
2. The audio input jack connects external audio sources to the electric piano for playback. (figure 2)

3 Headphone jack

Connecting the headphones will automatically cut off the output of the keyboard's built-in speakers, making it easier to play without disturbing others. (figure 3)

4 USB transmission interface

The USB transmission interface of this digital piano can be connected to the computer. Perform, compose, and store music by learning or playing the keyboard through pre-installed music software on the computer. Edited music and built-in accompaniment of music software can be played by software connected to inverted digital piano or played according to the accompaniment music. (figure 4)

5 Sound delay foot pedal interface

Plug the pedal wire end into the pedal interface of the pedal, you can connect the sound effect function of the pedal (figure 5)



Panel diagram

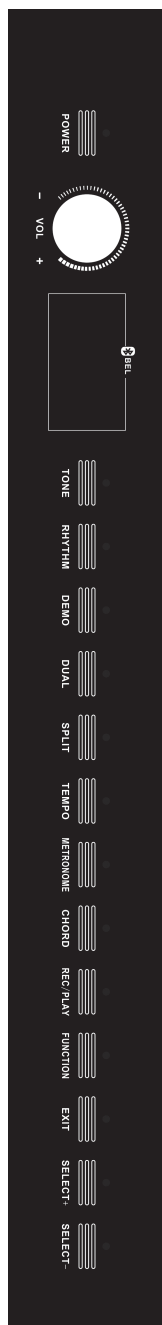

- Keyboard: 88 keys with heavy hammer keyboard
- Timbre: 128 timbre
- Rhythm: 100 kinds of rhythm
- Demo song: 88 pieces
- Output function: LED display
- Timbre control: double timbre and double keyboard metronome shift and dynamic equalizer
- Chord control: Single-finger and multi-finger chords
- Recording control: powerful program recording playback function
- Foot control: sound delay effect
- Other ports: USB port. Audio input/output port Power port Headphone port pedal port
- Dual Bluetooth system: Audio Bluetooth + data Bluetooth
- Bluetooth password: 8888
- Number of polyphony: 128

1 POWER

1. Press "power supply · switch to open position," power indicator light and digital display screen "light up, you can enter the performance state.
2. Play music on the piano keyboard.
3. Please turn off the power when not in use temporarily.

The processor chip of this product is complex, similar to that of a computer system. Sometimes it cannot respond, please turn off the power switch and then turn it on to work normally.

2 TONE

1. Press the "tone" button. When the button indicator lights up, enter the tone mode.
2. Press "select +" or "select -" any tone color, and the corresponding tone color number is displayed digitally.
3. Find the tones you need in the appendix. There are 128 tones in total.

3 RHYTHM

1. Press "RHYTHM", the button indicator will light up and enter the rhythm mode.
2. Press "SELECT+" or "SELECT-" to select any rhythm, the corresponding rhythm number displayed on the digital LED screen.
3. Find the rhythm you need in the appendix rhythm list. There are 100 rhythms.

4 DEMO

1. Press "DEMO", the digital LED screen displays the current demo song number, and the demo song starts to play.
2. Entering the demo song mode, you can also use "SELECT+" or "SELECT-" to select different demo songs.
3. Press "DEMO" again to exit the demo mode.
4. Find the music you need in the appendix song list

Note!

The built-in music library of this product contains 88 songs. The built-in music can be used for playback and appreciation, and can also be used for learning functions to follow the melody on the keyboard.

5 DUAL

1. Press the " DUAL" button to enter the two-tone mode.
2. When playing notes on the keyboard, two corresponding resonant timbres can be produced simultaneously. Using the dual tone function, two different tones can be mixed together to produce a sound, which can be mixed at will to create a new tone that resonates with the instrument.

6 SPLIT

1. Press the "SPLIT" button to enter the dual keyboard mode
2. Play notes on the keyboard. At this time, the left and right sides of the keyboard will emit corresponding instrument sounds.
 - Use the dual keyboard function to assign two different tones (main and split) to the two ends of the keyboard, so that you can play one tone with your left hand and the other with your right hand to create an ensemble effect .

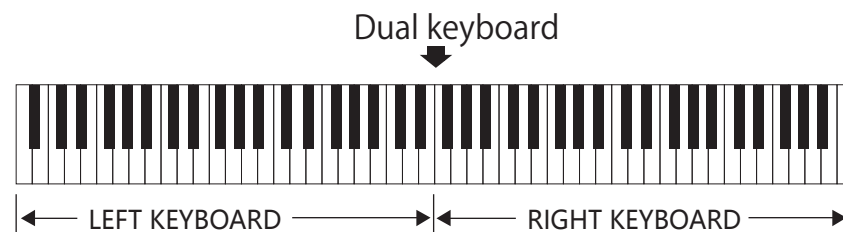

7 SPEED

1. Press the "SPEED" button and then press "Select +" or "Select -" button to adjust the speed.
2. Speed control range (20-280), factory setting value is 120.

8 METRONOME

Press the "METRONOME" button, and the corresponding indicator will light up. The metronome function will start and display "1-4", which is the first beat. Press again to display "2-4", which is the second beat. Press again to display "3-4", this is the third beat, press again to display "4-4", which is the fourth beat, press again, "METRONOME" is off.

9 CHORD

1. Select the rhythm you want to play. For details, refer to the 4th "RHYTHM" operation.
2. Press the "CHORD" button, the digital LED screen will display the chord and start to enter the chord state
 - Use the single-multi-finger multiplexed chord mode. If it meets the multi-finger chord playing method, the piano will respond to the multi-finger chord; if it does not meet the multi-finger chord playing method, it will recognize the response according to the single-finger chord.
3. To play chords, you can use different fingerings to perform different performances on the accompaniment keyboard (1-34 keys from the left).
4. Press the "CHORD" button again to turn off the chord state.

**10 REC/PLAY**

1. Keyboard note recording

Press and hold the "REC/PLAY" button for three seconds, the digital LED screen displays "REC", enter the recording mode, play the keys to enter the note recording, and then press "REC/PLAY", the recording ends.

In the keyboard note recording mode, the "tone" can be changed for recording, and 5000 notes can be recorded.

2. Press "REC/PLAY" again, "PLY" is displayed digitally, and the recorded notes are played.

3. Press "EXIT" or turn off the power to delete the recording.

11 FUNCTION

1. Press the first time to enter "Select +" or "select -" to turn on or off the force function.

2. Press the second and third times to enter the "function mode" button and enter the equalizer mode. The initial value of digital display "096" can be selected by selecting + or "Select -" to select the sound effect corresponding to different equalizer value (0-127).

3. Press the fourth time to enter the "Move mode" button, enter the move mode when the digital display "0". Use "Select +" or "Select -" to select different shift values (-12-12)

12 RESET

Press the "Reset" button to restore the function to its initial state.

Note!

- If you want to return to the original state of a feature, press "Reset" to do so. Effectively prevent digital piano often open/close start, the current brought to digital piano damage, effectively increase the life of digital piano.

**13 Bluetooth mode**

Turn on the power to connect bluetooth automatically, connect bluetooth password 8888

1. Connect mobile phone, tablet, computer: Turn on bluetooth device such as mobile phone, connect to PIANO-audio XXXX, complete the connection with the piano
2. Audio Bluetooth introduction: By using the music playing APP of mobile phones and other devices, you can play music and enjoy songs on the piano through bluetooth connection with the electronic piano
3. Introduction to Data Bluetooth: By using the music and playing APP of mobile phones and other devices, you can play games and practice songs on the piano through bluetooth connection with the electronic piano.

Note!

After starting Bluetooth, there will be Bluetooth communication and data scanning chip motherboard voice, which is a normal phenomenon. Please feel free to use it. After using Bluetooth, please turn off Bluetooth in time and disconnect bluetooth of mobile phones and other devices. Piano-audio XXXX: XXXX represents the last four bits of code connected to bluetooth devices such as mobile phones. Because each Bluetooth plate is different, the connection code is different, which is a normal phenomenon. Bluetooth connection password :8888

TONE LIST:

Number	Instrument
PIANO	
001	GRAND PIANO 1
002	BRIGHT PIANO 1
003	PIANO ELEC
004	HONKY-TONK
005	E PIANO1
006	E PIANO2
007	GRAND HARPSICHORD
008	CLAVI CHORD 1
GLOCK	
009	CELESTA
010	GLOCKENSPIEL 1
011	MUSIC BOX 1
012	VIBRAPHONE 1
013	MARIMBA 1
014	XYLOPHONE 1
015	TUBULR BELLS 1
016	DULCIMER 1
ORGAN	
017	HAND ORGAN 1
018	PERCHY ORGAN 1
019	ROCK ORGAN
020	CHURCH ORGAN 1
021	REED ORGAN 1
022	ACCORDN 1
023	HARMONICA 1
024	TANGO ACCORDN 1
GUITAR	
025	GUITAR NYLON 1
026	GUITAR STEEL 1
027	GUITAR JAZZ 1
028	GUITAR CLEAN 1

029	GUITAR MUTED 1
030	GUITAR OVRDRV
031	GUITAR DISTRT 1
032	GUITAR HRMNX
BASS	
033	ACOUSTIC BASS 1
034	FINGER BASS 1
035	ELECT BASS 1
036	FRETLS BASS
037	SLAP BASS 1
038	SLAP BASS 2
039	SYN BASS 1
040	SYN BASS 2
STRING	
041	VIOLIN 1
042	VIOLA 1
043	CELLO 1
044	CONTRABASS 1
045	STR TREM 1
046	STR PIZZ
047	HARP 1
048	TIMPANI 1
CONCERT	
049	STRINGS 1
050	STRINGS 2
051	STR SYN 1
052	STR SYN 2
053	CHOIR AAHS 1
054	VOICE OOHS 1
055	VOICE SYN
056	ORCH HIT 1
BRASS	
057	TRUMPT 1
058	TROMBONE 1
059	TUBA 1
060	MUTE TPT 1
061	FR HORN 1
062	BRASS SECT 1
063	BRASS SYN 1
064	BRASS SYN 2
PIPE	

065	SAX SOPRANO
066	SAX ALTO 1
067	SAX TENOR 1
068	SAX BTONE 1
069	OBOE 1
070	ENG HORN 1
071	BASSON 1
072	CLARINET 1
WOODPIPE	
073	PICCOLO 1
074	FLUTE 1
075	RECORDER 1
076	PAN FLUTE
077	BOTTLE BLOWN
078	SHAKHACHI
079	WHISTLE 1
080	OCARINA
SYNTH PIPE	
081	SQR WAVE
082	SAW TOOTH
083	CALLIOPE
084	CHIFF
085	CHARANG
086	VOICE
087	FIFTHS
088	BASS LEAD
SYNTH VOICE	
089	NEW AGE
090	WARM PAD
091	POLY SYNTH
092	CHOIR PAD 1
093	BOW GLASS 1
094	METAL PAD 1
095	HALO PAD 1
096	SWEEP
SYNTH EFFECT	
097	RAIN FX
098	SNDTRK FX
099	CRYSTAL FX
100	ATMOSPH FX

101	BRIGHT FX
102	GOBLIN FX
103	ECHO FX
104	SCI-FI FX
FOLK SOUND	
105	SITAR 1
106	BANJO 1
107	SHAMISEN 1
108	KOTO 1
109	KALIMBA
110	BAGPIPE
111	FIDDLE
112	SHANAI
PERCUSSION	
113	TINKLE BELL
114	AGOGO
115	STEEL DRM
116	WOODBK
117	TAIKO DRM
118	MLDY TOM
119	SYNTH DRM
120	REVRS CYM
EFFECT	
121	GTR NOISE
122	BREATH 1
123	SEASHORE
124	BIRD TWEET 1
125	TELEPHONE
126	HELICOPTER
127	APPLAUSE
128	GUNSHOT 1

RHYTHM LIST:

8 BEAT	001	8 Beat 1A
	002	8 Beat 2A
	003	8 Beat 3A
	004	8 Beat 4A
	005	8 Beat HeatA
	006	8 Beat Pop 1A
	007	8 Beat Pop 2A
BALLAD	008	Ballad 1A
	009	Ballad 2A
	010	Guitar Ballada
	011	Organ Ballada
	012	Bluse Ballada
	013	Epic Ballada
	014	Rock Ballada
	015	Slow Ballada
	016	Pop Ballada
	017	Electro Pop Ballada
	018	Polk Ballada
	16 BEAT	019
020		16 Beat 2A
	021	16 Beat 3A
	022	16 Beat 4A
	023	16 Beat FunkA
	024	16 Beat Pop A
	025	16 Beat Ballada
	LATIN	026
027		Guitar BossaA
	028	Pop BossaA
	029	TangoA
	030	Cha ChaA
	031	RhumbaA
	032	TEX TEXA
	COUNTRY	033
034		Country RockA
	035	Country ShuffleA
	036	Country SwingA
	037	Country Ballada
	038	Country Waltza

ROCK R&B	039	50's RockA
	040	Heavy MetalA
	041	Rock 1A
	042	Rock 2A
	043	Soft RockA
	044	Slow RockA
	045	Hard RockA
	046	Rock & Roll 1A
RHYTHM&BLUES	047	Rock & Roll 2A
	048	Chicago BluesA
	049	Fast GospelA
	050	Groove Soula
	051	RapA
	052	GospelS1A
	053	BluesA
	054	Slow BluesA
	055	FoxtrotA
Disco	056	Disco TropicA
	057	Disco HandsA
	058	Two StepA
	059	Polk PopA
	060	Waltz 1A
	061	Waltz Pop 1A
	062	Waltz Pop 2A
	WORLD MUSIC	063
064		Twist 1A
065		Twist 2A
066		Miami PopA
067		MotownA
068		ReggaeA
069		Swing ReggaeA
070		MamboA
071		BeguineA
072		MusetteA

DANCE	073	HouseA
	074	Slow FoxA
	075	Vienna WaltzA
	076	SalsaA
	077	DiscoA
	078	Hip Hop PopA
	079	Analog PopA
	080	Club DanceA
JAZZ&SWING	081	BoogieA
	082	Funky PopA
	083	Jazz RockA
	084	Swing 1A
	085	DixielandA
	086	Jazz SambaA
TRADITIONAL	087	MarchA
	088	US. MarchA
	089	Samba A
	090	PolkaA
	091	Polka OberA
	092	TarantellaA
	093	Slow WaltzA
	094	Ober WaltzA
PINIST	095	Piano BalladA
	096	Waltz 2A
	097	Guitar WaltzA
	098	2/4 Piano 1A
	099	3/4 Piano 1A
	100	4/4 Piano 1A

DEMO LIST:

NO	SongName
001	MinutWlz
002	DJ Dance
003	Fountian
004	SpanGirl
005	SonataPn
006	SuperSng
007	LittlBee
008	HorseRac
009	Nocturne
010	TheSpain
011	BusyTran
012	Mexico
013	MozartPn
014	Minuet
015	Nifuma
016	Disco
017	FolkSong
018	Girl Sea
019	LittStar
020	KindeGtn
021	Wahaha
022	Duck&Cik
NO	SongName
023	Humorous
024	Joy Song
025	GoingHom
026	Dove
027	Auldlang
028	Moonligh
029	HapyBirh
030	PraiseSng
031	Dolly
032	Market
033	Family
034	A cradle
035	At Home
036	Seasons
037	YearsAgo
038	Pigeons
039	InnerVic
040	Violin
041	Swan
042	Musettes
043	GypsyRnd
044	Serenade

NO	SongName
045	Polka
046	SoilPull
047	Trout
048	Send-off
049	March
050	ForElise
051	SwaniRiv
052	France
053	Danube
054	Hungary
055	Spaceman
056	Patriot
057	Cuckoo
058	SingKite
059	TongChil
060	DoReMi
061	We Happy
062	LittlBee
063	Russia
064	Plaster
065	Foison
066	JingleBe
NO	SongName
067	PaperBoy
068	Swallow
069	New Year
070	Edelweis
071	MoonRivr
072	Beyer 10
073	Beyer 20
074	Beyer 30
075	Beyer 40
076	Beyer 50
077	Beyer 60
078	Beyer 70
079	Beyer 71
080	Beyer 72
081	Beyer 75
082	Beyer 76
083	Beyer 77
084	Beyer 78
085	Beyer 79
086	Beyer 80
087	Beyer 90
088	Beyer 98

product maintenance

Excellent maintenance and maintenance of the product can prolong the service life of the product and play a very important role in reducing failures.

Humidity and direct sunlight. Please do not overexpose to sunlight, air conditioning near or high temperature.

Do not use near TV or radio.

This product may cause interference between video and audio on television and radio.

In this case, keep the product away from the TV or radio.

Please do not clean with paint, thinner or similar chemicals.

This product can be wiped with a soft cloth immersed in a neutral solution and a neutral cleaner.

Avoid serious collisions to avoid damaging the housing and internal electronic components.

If the temperature is too high or too low, the image on the LED screen will turn gray and be difficult to read.

If the product is used at room temperature, the LED) screen will be automatically repaired.

Guarantee

1. If any quality problem occurs during normal use of the product (subject to the date of purchase and payment), you can enjoy one year free warranty service.
2. During the warranty period, a material fee will be charged if the damage is due to incorrect use or man-made causes.
3. No free warranty is provided under the following conditions.
 - a: There are no screenshots of the payment to prove the date of purchase
 - b: The purchase date has been changed
 - c: Damage caused by user misuse
 - d: Failure caused by force majeure (e.g. fire, flood, earthquake and lightning strike).
 - e: Failure due to unauthorized disassembly